

**Glass railing to be installed  
on slab or wall mount**

**COLLECTION V - ALUMINUM AND GLASS**



■ **MODEL V150**

# V150 ■ Glass railing to be installed on slab

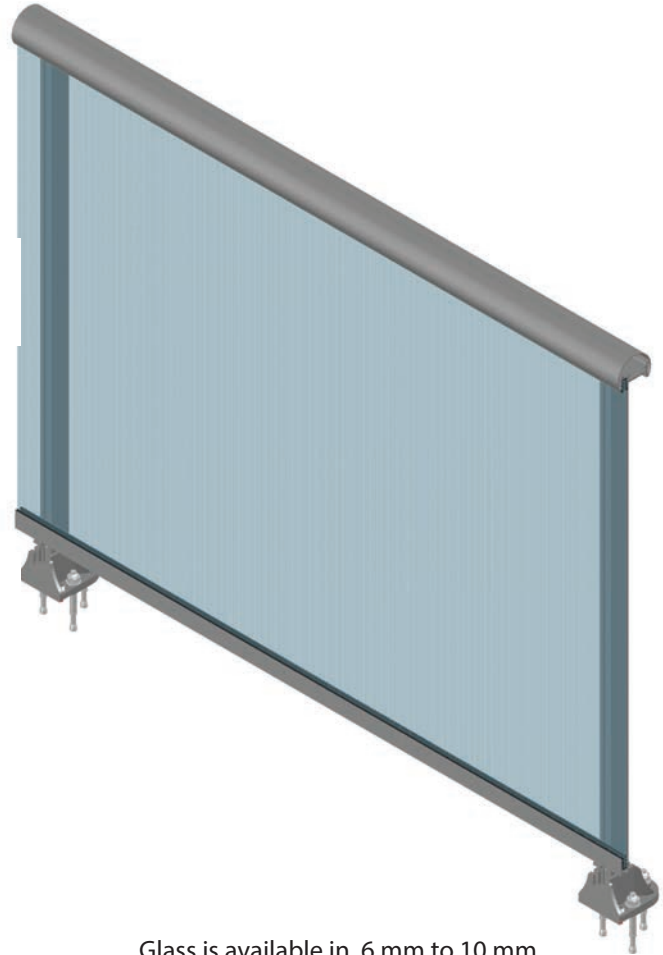
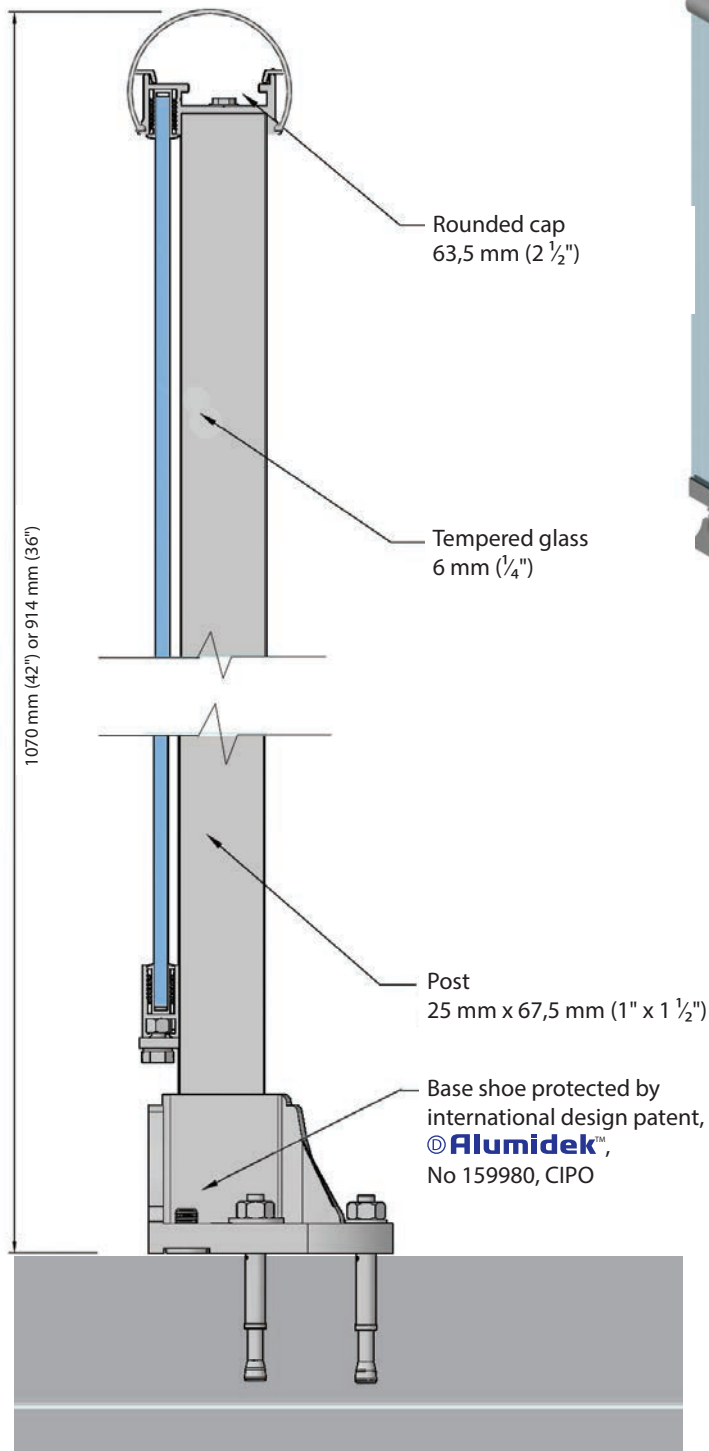

Glass is available in 6 mm to 10 mm (1/4" to 3/8") thickness, tempered or laminated. Various colors of aluminum and glass patterns available.

## Type of handrail

Square  
63,5 mm x 32 mm  
(2 1/2" x 1 1/2")

Rounded  
63,5 mm  
(2 1/2")

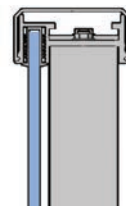

## Standard Colors

Anodized grey    Commercial brown    White    Black



\* other colors and finishes available on custom orders

# V150M ■ Glass railing to be installed wall mount

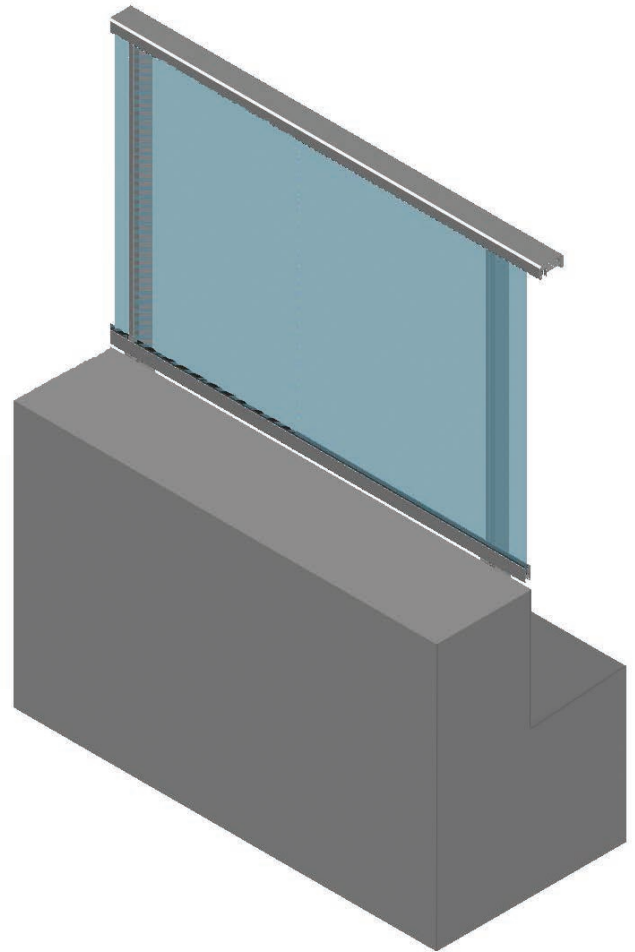
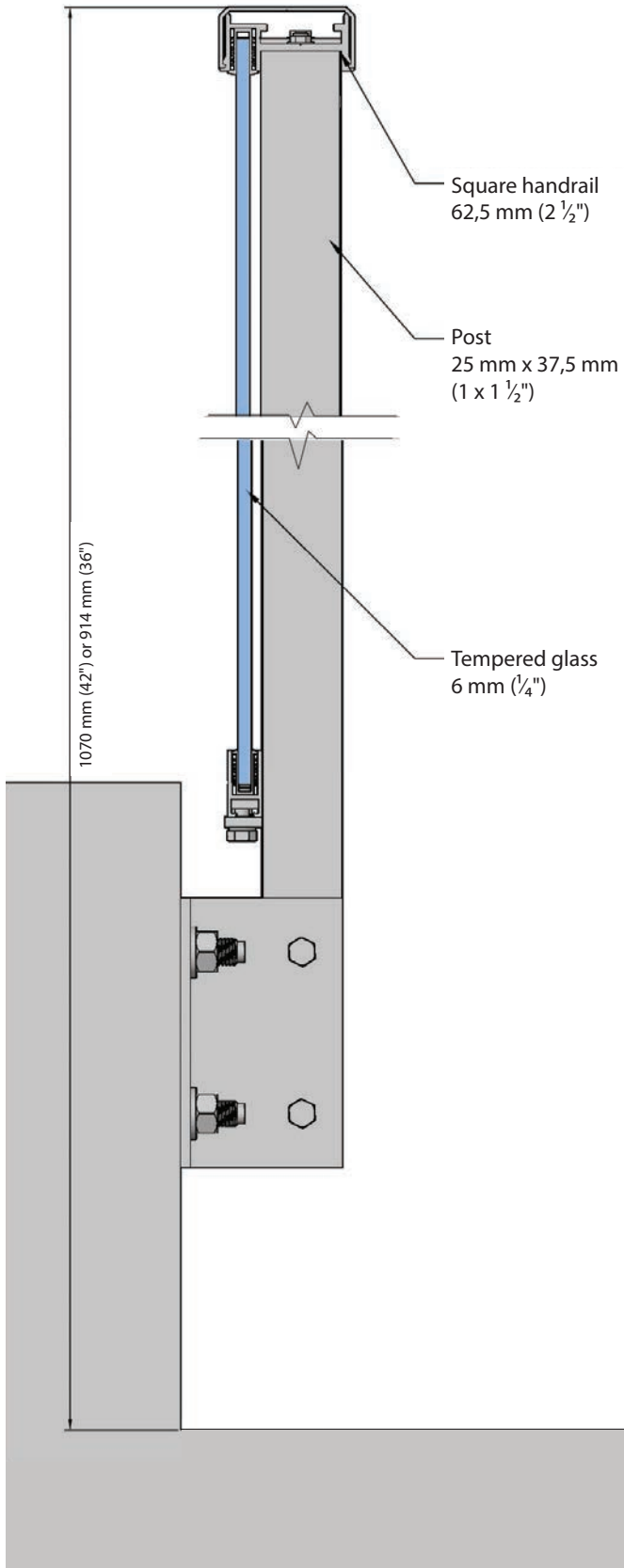

Glass is available in 6 mm to 10 mm (¼" to ⅜") thickness, tempered or laminated. Various colors of aluminum and glass patterns available.

## Type of handrail

Square  
62,5 mm x 32 mm  
(2 ½" x 1 ¼")

Rounded  
63,5 mm  
(2 ½")

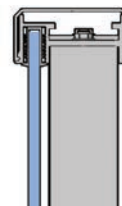

## Standard Colors



\* other colors and finishes  
available on custom orders

# Many options available

## ■ Above slab

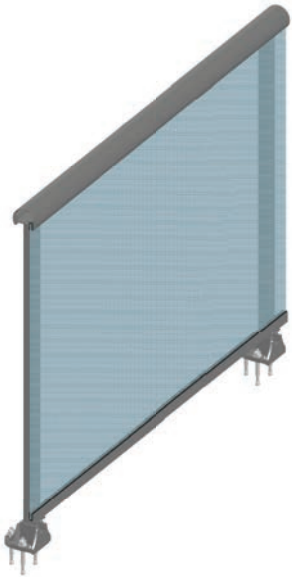

**V150**  
Exterior panel

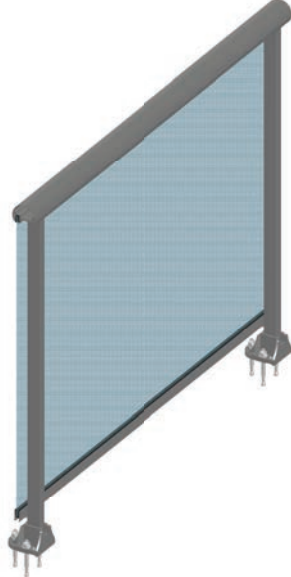

**V150i**  
Interior panel

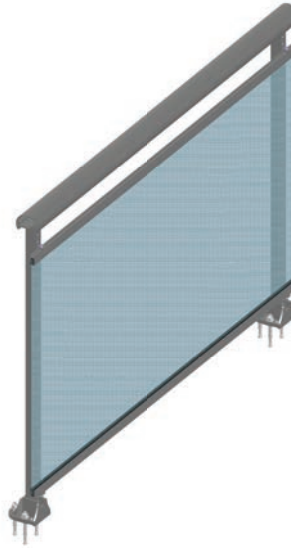

**V150A**  
Exterior panel  
with gap

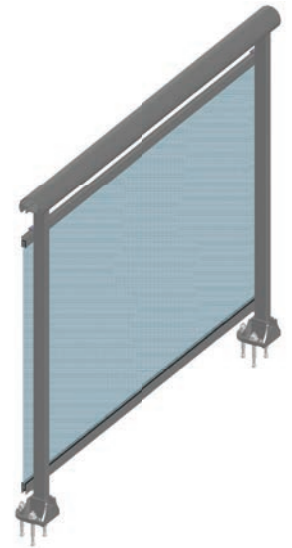

**V150Ai**  
Interior panel  
with gap

## ■ Above wall

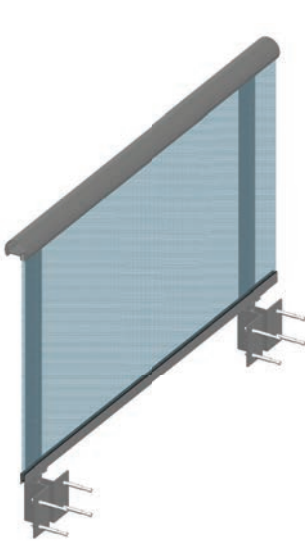

**V150M**  
Exterior panel

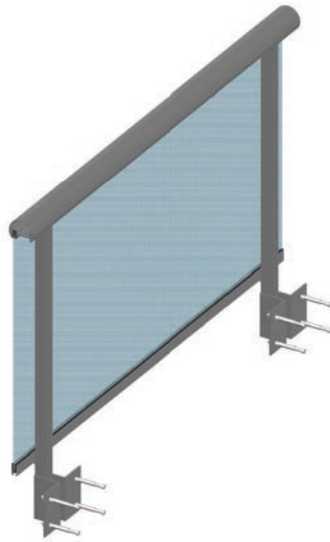

**V150iM**  
Interior panel

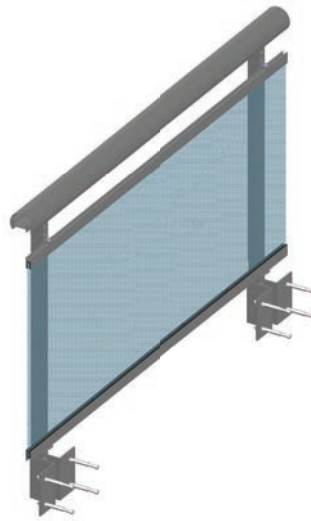

**V150AM**  
Exterior panel  
with gap

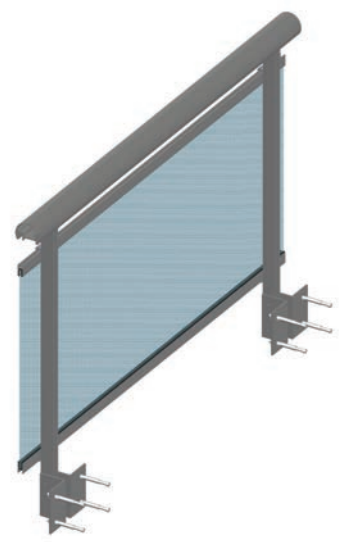

**V150AiM**  
Interior panel  
with gap